



Specialised
Orthotic
Services

POZIFORM®

5 POINT HARNESS

Installation & User Instructions

POZIFORM® is a registered trademark of Specialised Orthotic Services Ltd.

Thank you for purchasing your **POZIFORM® 5 POINT HARNESS**

These comfortable, lightweight range of harnesses provide positive postural support and control to the upper body & pelvic area for the wheelchair user.

All **POZIFORM®** products are supplied with a comprehensive 3 months warranty from the date of purchase (For terms and conditions please consult our Customer Services Department).

Please note that the 5 Point harness should be used in conjunction with the **FITTINGS** supplied and **must not** be used as a transportation safety belt in a moving vehicle.

To fit your **POZIFORM®** Bib Harness please follow these instructions supplied.



5 Point Harness.

Specialised Orthotic Services Ltd

Units 127/128 Fauld Ind Park

Tutbury, Nr Burton-on-Trent,

Staffordshire. ENGLAND. DE13 9HS

Tel: 0044 (0)1283 520 400 Fax: 0044 (0)1283 520 401

E-mail: enquiries@specialorthotic.com

Web: specialisedorthoticservices.co.uk



KIT LIST & TOOL REQUIREMENTS

Your Harness Kit Consists Of The Following:



1 x Fitting Instructions
1 x 5 Point Harness
2 x Upper Strap



5 x Webbing Slides
5 x Cam Buckles

Tools Required (not supplied):

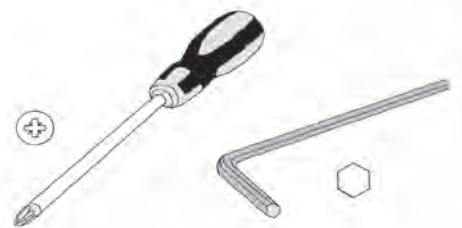

1 x No.2 Pozidriv Screw Driver & 1 x 3mm Allen Key



Drill & Drill Bit (for fitting to Hard Base or Special Seating Systems).

CLEANING & MAINTENANCE

Cleaning Instructions:

Clean down with a damp cloth and a mild detergent.
When wet allow to dry naturally in a warm dry atmosphere.
DO NOT dry in any drying machine.
DO NOT wash in an automatic washing machine.
DO NOT iron.

Maintenance Instructions:

CHECK for any signs of fraying and that buckles work correctly.
CHECK & make sure that all fixings are secure & not damaged, especially after making any adjustments.
PERIODIC cleaning will help prevent damage to buckle.

FITTING INSTRUCTIONS

BEFORE fitting the harness to any wheelchair/seating system please consult the manufacturers hand book (or contact them direct) to find out if it is safe to do so.

1) Fitting to Hard Base or Special Seating Systems: The following fitting instructions are a guideline only as seating systems vary according to manufacturer.

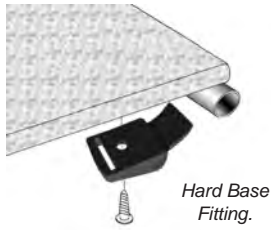

1.1) Drill each Cam Buckle with a 6mm drill and attach Cam Buckle to underside of base/seating system using a self tapping screw or rivet with a nominal size of 5mm dia (not supplied).

- Note:**
- a) A slot may have to be cut into the base/seating system to allow correct positioning of groin strap.
 - b) The Cam Buckles for the side straps could also be fitted to rear of seat depending upon required position.

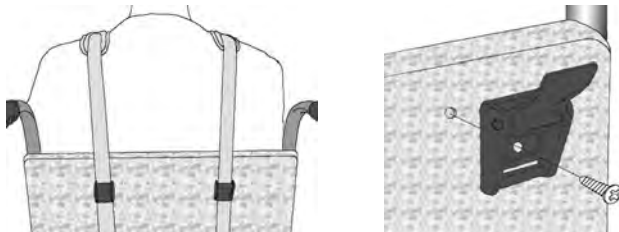

1.2) Attach upper straps to the harness then Sit user in seat and place harness over the shoulders, mark position of Cam Buckles in line with shoulder straps (as shown), remove harness and user from seat. Drill each Cam Buckle with a 6mm drill and attach Cam Buckle to rear of back rest using a self tapping screw or rivet with a nominal size of 5mm dia (not supplied)

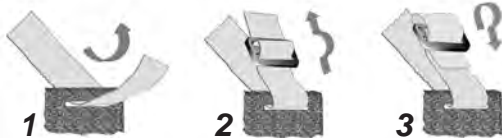

1.3) Cut slot in Seating System to clear webbing and pass the webbing through. Slide on the webbing slide and thread the webbing back into the slide to tighten.

2) User Guide: The following user instructions are applicable which ever way the harness is fitted to the wheelchair or Seating System.

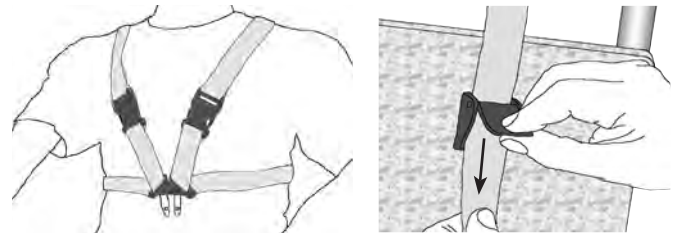

2.1) Place the upper straps over the users shoulders, pull the straps through the Cam Locks and close the top to clamp them in place. Clip the two upper strap buckles together & bring the two male parts of the centre buckle together

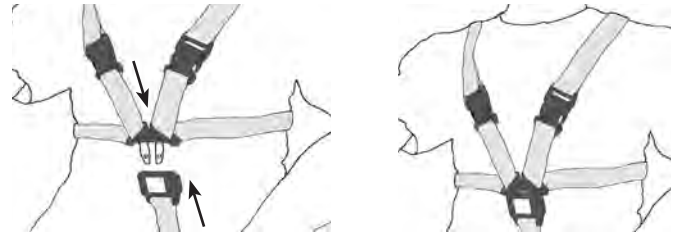

2.2) Hold the two male parts of the centre buckle together and clip into the female half on the groin strap. Make sure the webbing slides (if used) are close to the seat and tighten straps.

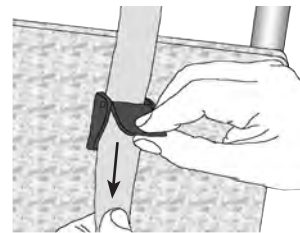

2.3) Pull the straps through the five Cam Locks until the harness is not too loose to be ineffective nor too tight to cause discomfort and that the centre buckle is located close to the sternum. Close the five cam buckle tops to clamp the Harness in place. Make sure that there is no more than 150mm (6") of webbing coming from the cam buckle to the end of the strap. Cut off any excess webbing and seal cut end with match/lighter.

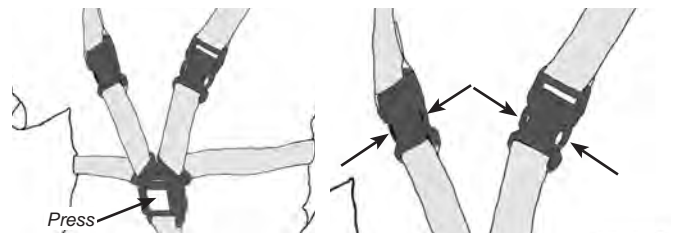

2.4) To remove the 5 Point Harness:

- i) Press the red button on the buckle and pull the lower straps away from the client.
- ii) Grasp the upper buckle on the Harness, press the side buttons and pull the upper straps away from the harness if required.