

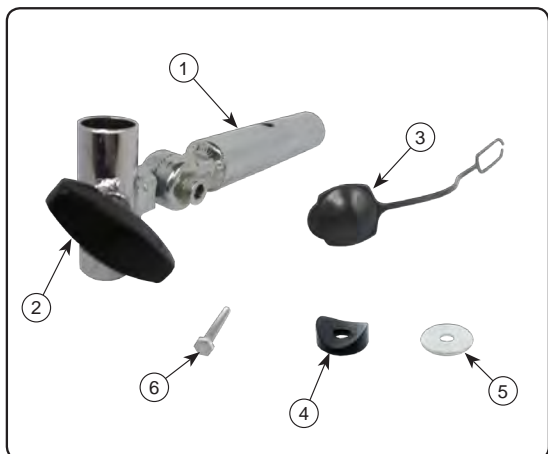

Specialised
Orthotic
Services

Units 127/128
Fauld Industrial Park
Tutbury, Nr Burton upon Trent, Staffordshire.
DE13 9HS
Tel: 0044 (0)1283 520 400
Fax: 0044 (0)1283 520 401
E-mail: enquiries@specialorthotic.com
Web: www.specialisedorthoticservices.co.uk

TRAY SOCKET FITTING INSTRUCTIONS



CONTENTS

You should have the following:

1. Tray Socket* (2 off)
2. M6 Wing Knob (2 off)
3. Cap (2 off)
4. Radius Washer (2 off)
5. M5 Washer (2 off)
6. M5 x 40 Set Screw (2 off)

*This maybe a Fixed or Adjustable tray socket (Adjustable shown)

If any of the above items are missing, please contact our Customer Services Department on 0044 (0)1283 520400.

1. FITTING TRAY SOCKET

- Remove the front Screw from Armrest Pad (Fig.1a).
- Plug the Cap into the Tray Socket, lift up the Pad and slide the Tray Socket on to the front of the Armrest (Fig.2b) making sure the Wing Knob is to the outside of the wheelchair and that the loop on the Cap is aligned with the hole in the Tray Socket.



1. FITTING TRAY SOCKET (Cont.)

- Align holes in Tray Socket, Cap, Armrest & Arm Pad.
- Insert the M5 x 40 Set Screw along with the M5 Washer & Radius Washer from under the Tray Socket (Fig.1c), tighten in place.
- Completed RH Armrest as shown (Fig.1d), repeat for other side.

